

A Project by



Where Quality Prevails

Vazhraa Nirmaan



Live life your way...



*Live your dreams in
nature's Paradise...*



hmda
APPROVED
GATED COMMUNITY
@ NIZAMPET

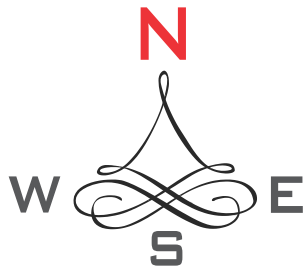

Where nature
sets the mood!

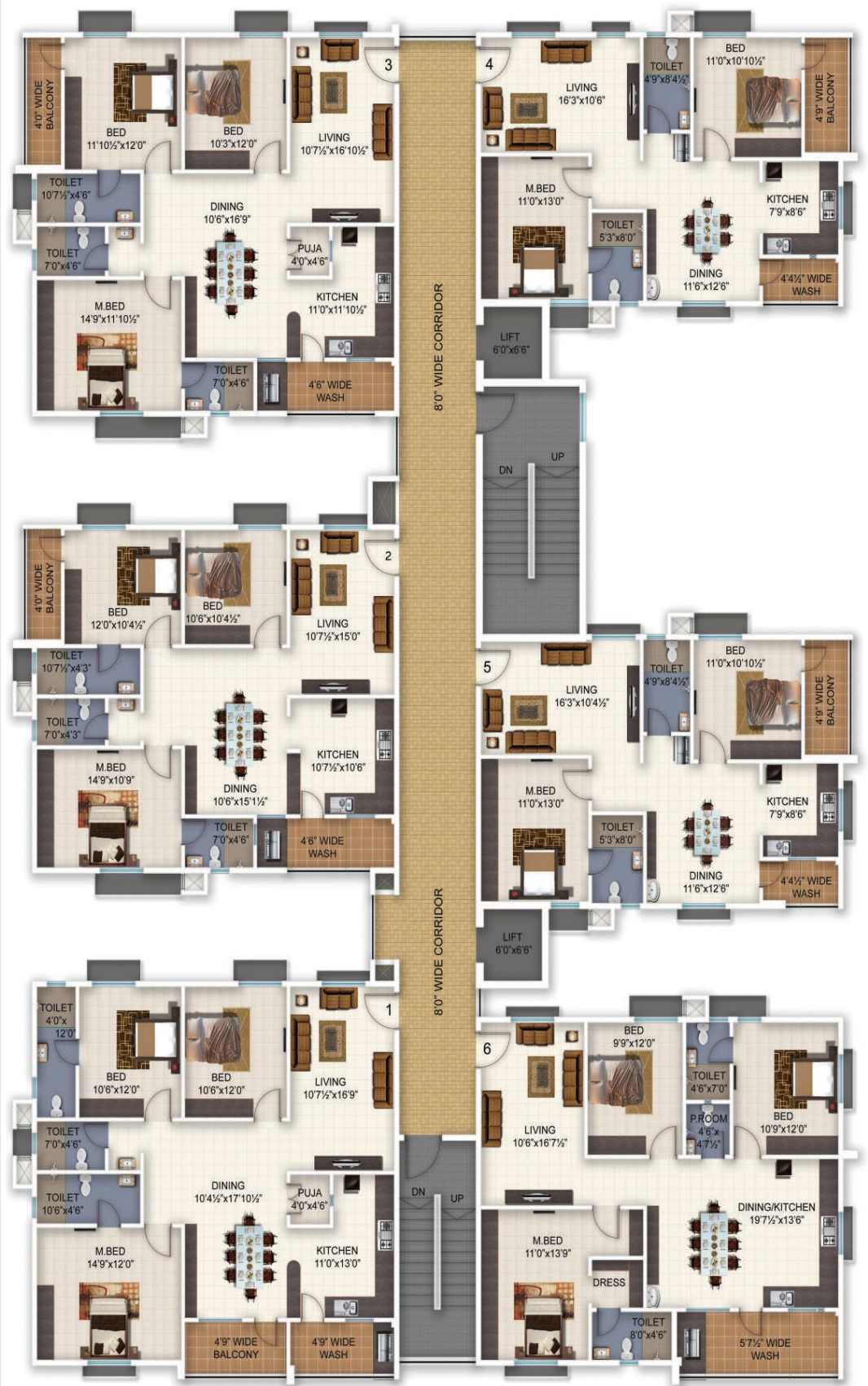

TYPICAL FLOOR PLAN - BLOCK A



Area Statement

Flat Series No.	Super Builtup Area
1	1705 Sft
2	1530 Sft
3	1685 Sft
4	1205 Sft
5	1205 Sft
6	1540 Sft

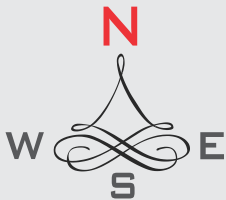

Live your dreams in nature's Paradise...

TYPICAL FLOOR PLAN - BLOCK B

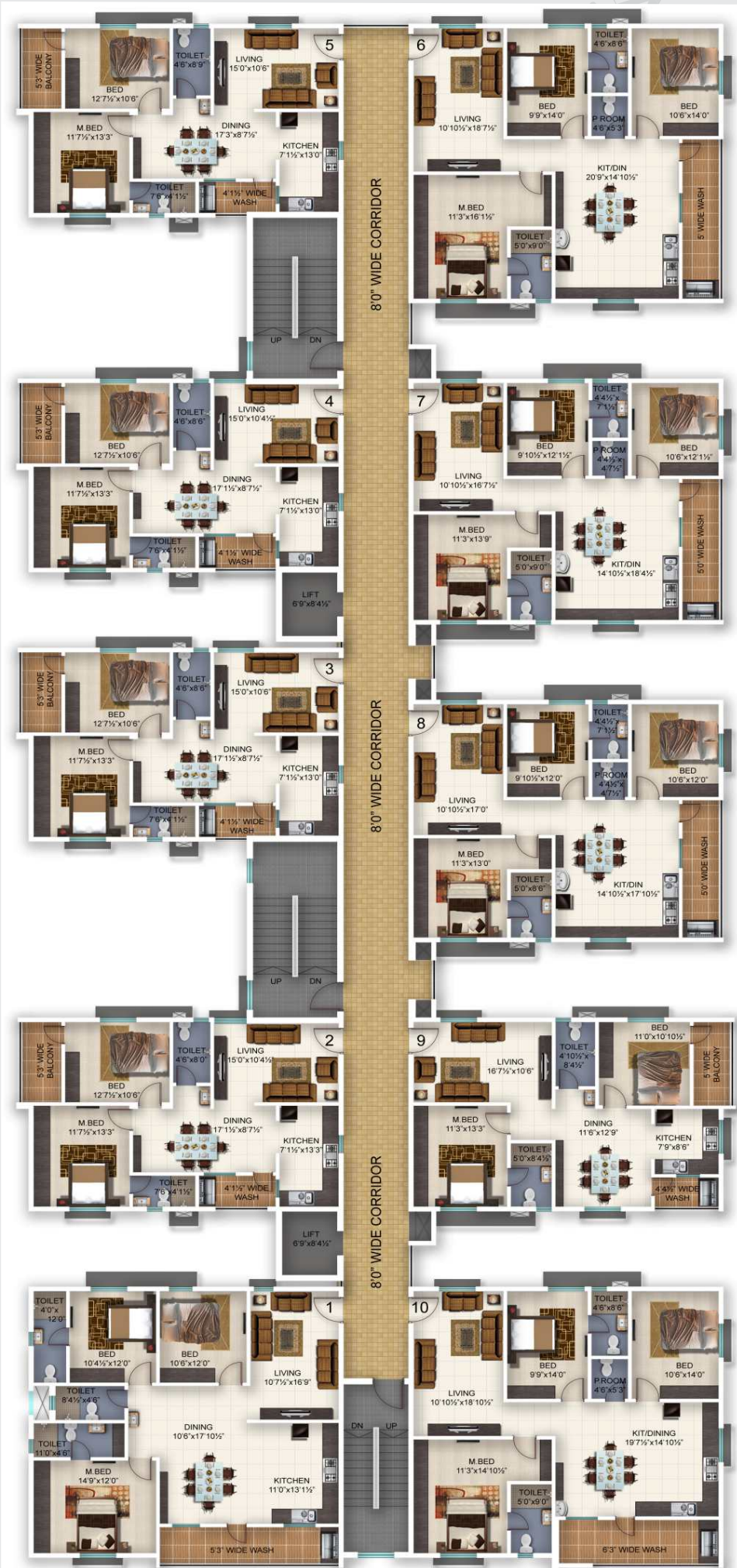

Area Statement

Flat Series No.	Super Builtup Area
1	1705 Sft
2	1205 Sft
3	1205 Sft
4	1205 Sft
5	1205 Sft
6	1720 Sft
7	1515 Sft
8	1490 Sft
9	1205 Sft
10	1695 Sft

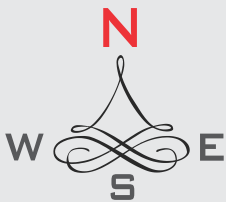

TYPICAL FLOOR PLAN - BLOCK C



Area Statement

Flat Series No.	Super Builtup Area
1	1205 Sft
2	1205 Sft
3	1205 Sft
4	1205 Sft
5	1205 Sft
6	1515 Sft
7	1205 Sft
8	1205 Sft
9	1515 Sft

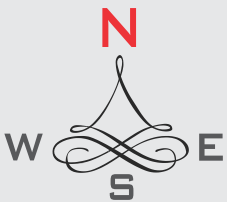

TYPICAL FLOOR PLAN - BLOCK D

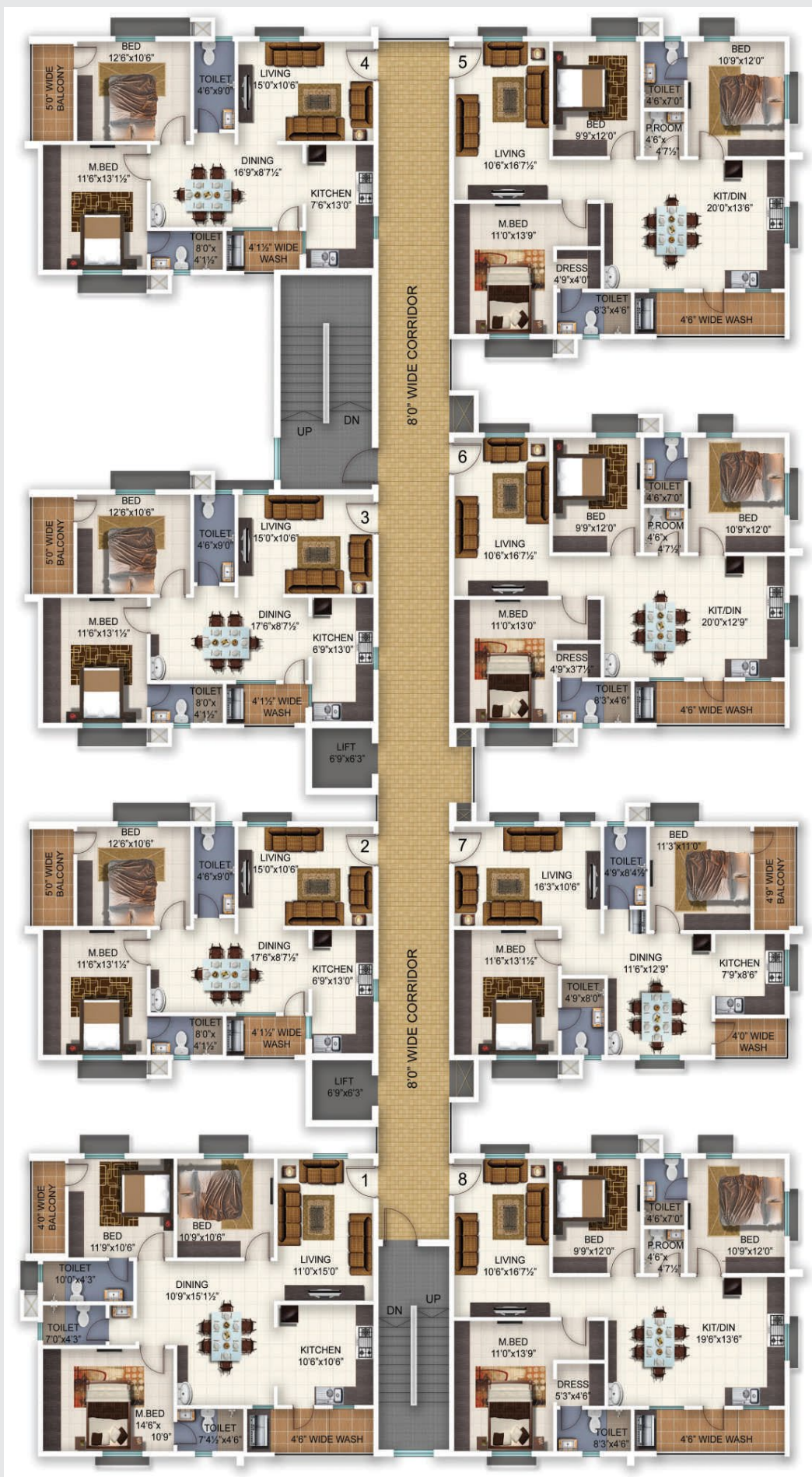

Area Statement

Flat Series No.	Super Builtup Area
1	1530 Sft
2	1205 Sft
3	1205 Sft
4	1205 Sft
5	1515 Sft
6	1475 Sft
7	1205 Sft
8	1515 Sft

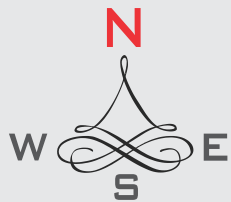

TYPICAL FLOOR PLAN - BLOCK E

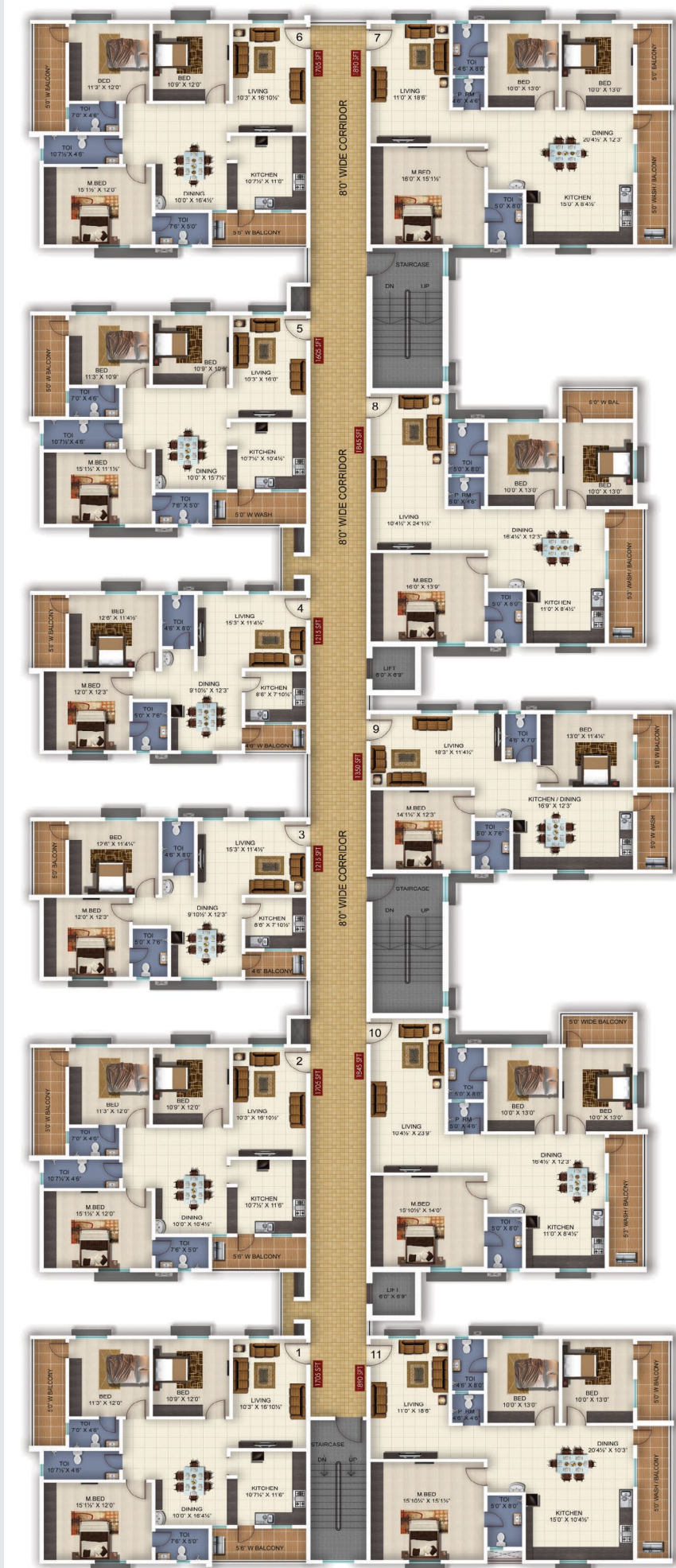



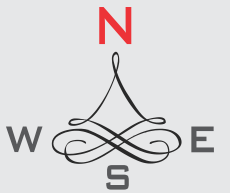

Area Statement









Flat Series No.	Super Builtup Area
1	1705 Sft
2	1705 Sft
3	1215 Sft
4	1215 Sft
5	1605 Sft
6	1705 Sft
7	1890 Sft
8	1845 Sft
9	1350 Sft
10	1845 Sft
11	1890 Sft



SPECIFICATIONS

	STRUCTURE	: Reinforced Cement Concrete Framed structure.
	SUPER STRUCTURE	: 6” External wall and 4.5” internal wall with quality Fly Ash bricks in cement mortar.
	FINISHES	: INTERNAL : Smooth plastered surface treated with lappam / putty and painted with emulsion. EXTERNAL : Sand finished plaster surface with weather proof paint of approved make.
	FLOORING	: ALL ROOMS : 2’x2’ vitrified tiles of standard make. TOILETS/BALCONIES : Anti skid ceramic tiles for toilets and balconies.
	DOORS & WINDOWS	: MAIN DOOR : Teak wood door frame and shutter aesthetically designed with melamine polish, fitted with good quality hardware and locking system of reputed make. OTHER DOORS : Teak wood frame with good quality waterproof flush shutter with quality hardware and lock. WINDOWS : UPVC Frames with plain glass and additional mosquito screen.



	KITCHEN	: Cooking platform of Granite and Stainless steel sink with water tap & Provision for Aqua guard.
	WATER SUPPLY	: Adequate water supply for all flats with over head tank and under ground sump.
	TILE DADOING	: KITCHEN : Glazed ceramic tile dado upto 2’ height above kitchen platform. TOILET : Class designer wall tile dado upto 7’ height of quality makes. UTILITY/WASH : Glazed ceramic tile dado upto 3’ height.
	SANITARY	: Wash basin of standard make. EWC with push valve type of flushing of standard make. Provision for Geyser & Exhaust fan. All CP fittings of standard make.
	ELECTRICAL	: 3 Phase power supply for each individual flat. PVC Piping of Sudhakar or equivalent makes. Concealed copper wiring of standard make. AC points for all Bed rooms. Power points for cooking range, chimney, microwave, refrigerator, mixer, grinder in kitchen and Geyser point in Toilets. Modular switches of standard make.
	VERTICAL CIRCULATION	: Lift of standard make as per design / Approval.
	POWER BACKUP	: Generator power for lifts, bore wells, common area lighting and 1KVA capacity for each flat.
	PARKING	: Adequate car parking is available.
	AMENITIES	: Club house of built-up area equivalent to 3% of the total residential area as per HMDA norms.

Enjoy all the comforts of a luxury home...

UNIQUE FEATURES

Water from HMWSSB will be provided
Exclusive fire fighting system
Sewage Treatment plant
Generator backup
Children play area and Landscaped Garden
LPG Piped Gas
Club House
24X7 Security
Adult & Baby Swimming Pool
Solar fencing all around the boundary



Designed to spread the cheer of good living.

PUSHPAK is located in one of the most prominent geographies of Hyderabad. Owing to many landmarks in the vicinity, it’s one of the most sought-after addresses in the city. But walk back a few steps, and you’ll find yourself inside a home that’s getting prepared to celebrate a class and elegance so different. Exquisitely planned and brilliantly designed - it’s a home that compliments today’s living, one that personifies truly global standards along with essential elements like ventilation, greenery and quality.



LOCATION PLAN



Builders & Promoters Vazharaa Nirmaan Pvt.Ltd



Corporate Office
1st Floor, Bhavana Enclave,
VI-Phase, KPHB Colony, Hyd-85.



vazhraanirmaan@gmail.com



www.vazhraanirmaan.com



9848021614, 9246186548



Marketing Office
Behind Karur Vysya Bank,
Blooming Dale Road,
Nizampet Village, Hyd-90.



sales@vazhraanirmaan.com



www.vazhraanirmaan.com



9246186545, 9246186547
9246186549, 8977232232



Architects & Engineers

Akshaya Infra Consultants Pvt Ltd



Corp. Office
1st Floor, Bhavana Enclave,
VI-Phase, KPHB Colony,
Above More Supermarket, Hyd-85,
Ph : +91-40-23154848, 4949, 4999.
E-mail : akshaya@akshayainfra.com



THIS PROJECT IS FUNDED BY

TATA CAPITAL
HOUSING FINANCE LIMITED

Home loans are brought to you by
Tata Capital Housing Finance Limited and are at their sole discretion.
Terms and conditions apply.



Note : This brochure is only a conceptual presentation of the project and not a legal offering. The promoters reserve the right to make changes in elevation, specifications and plans as deemed fit.

All are Perceptive Images only.